

30/06/2018

Mridul Dm.

Murali Das.

Rita Mitra

**SCHEDULE "G" AS PREFERRED TO HEREIN ABOVE**

**(Common Expenses)**

1. The expenses of maintaining, repairing, decorating, etc. of the building and in particular of roof, water tanks, Gutters and main water pipers of the building, water pipe and electrical wires in under and upon the common portion of the building and enjoyed and used by the **PURCHASERS/PRESENT OWNERS** in common with other co-occupiers/Co-Owners of other flats and the main entrance passage, Parking landing and stair case of the building and the boundary walls of the building compounds, etc.
2. The cost of cleaning and lighting the passage, landing stair case and other parts of the buildings so enjoyed or used by the other chaser as aforesaid.
3. The costs of the salaries of clerks, bill collectors, sweepers, Watchman etc, as may be appointed by apartment Owners/ Possessors.
4. The cost of working and maintenance of water connection light, lifts, pumps and other services.
5. Municipal and other taxes, Khajnas.
6. Such other expenses as are necessary of incidental for the maintenance and up keep of the building.

**SCHEDULE "H"**

All the obligations to be performed by the OWNER as in this Development

USUS JUL 15



1207/18  
4/5/20  
Muzidul Das  
Muzidul Das  
Rita Mitra

Agreement and under the Ownership Apartment Act and allied thereto and in case of his transfer of his allocation by the subsequent transferee too.

**SCHEDULE "I"**

**Payment Schedule:-**

| <b><u>Stage of Payment</u></b>                                    | <b><u>Amount of Payment</u></b>   | <b><u>Cheque issued in favour of</u></b> |
|---|---|--|
| Advance Payment prior to execution of said Development Agreement. | <b>Rs. 50,000/- (Fifty Thousand)</b> only, by an Account Payee Cheque with Cheque No 000086 dated 18/07/2020.                   | Smt. Shankari Das.                       |
| After Execution/Registration of said Development Agreement.       | <b>Rs. 2,50,000/- (Two Lakhs &amp; Fifty Thousand)</b> only, by an Account Payee Cheque with Cheque No 000090 dated 30/07/2020. | Smt. Shankari Das.                       |

54 JUL 2020  
Co-Op. Regd. Office



35  
 श्री १११११  
 श्री १११११  
 श्री १११११  
 श्री १११११

|  |   |                             |
|--|---|-----------------------------|
| <p>Within 30 days from the date of demolition of existing house of <b>OWNERS/ 1<sup>st</sup> Part.</b></p>                               | <p><b>Rs. 3,00,000/- (Three Lakhs)</b> only, by an Account Payee Cheque with Cheque No 000088 dated 01/09/2020.</p> | <p>Smt. Shankari Das.</p>   |
| <p>Within 60 days from the date of Sanction of Building Plan.</p>  | <p><b>Rs. 2,00,000/- (Two Lakhs)</b> only, by an Account Payee Cheque with Cheque No 000089.</p>                    | <p>Smt Shankari Das.</p>    |
| <p>Within 60 days from the issuance of Completion Certificate/Handing over of possession of Owner's Allocation (whichever is later).</p> | <p><b>Rs. 24,00,000/- (Twenty Four Lakhs)</b> only.</p>   | <p>To be decided later.</p> |

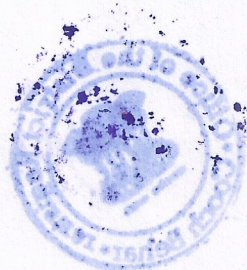

5 JUL 2020  
 Government of India



**SCHEDULE – 'J' (SITE PLAN)**

MOUZA – SAHAR COOCHBEHAR J. L. – 130, THAK NO. – 914, P.S. – KOTWALI,

DIST. – COOCHBEHAR, WARD NO. – 18, HOLDING NO. – 493/13051

LAND BELONGS TO

1. SMT SHANKARI DAS
2. SRI MRIDUL KUMAR DAS
3. SRI MRINAL KUMAR DAS
4. SMT RITA MITRA
1. WIFE OF Lt. MIHIR KUMAR DAS
2. SONS OF Lt. MIHIR KUMAR DAS
3. SONS OF Lt. MIHIR KUMAR DAS
4. DAUGHTER OF Lt. MIHIR KUMAR DAS

POSSESSION HANDED OVER TO

EVANGEL INDIA INFRASTRUCTURE PVT. LTD.  
 OFFICE- A/86 LAKE GARDENS,  
 GROUND FLOOR,  
 KOLKATA - 700045

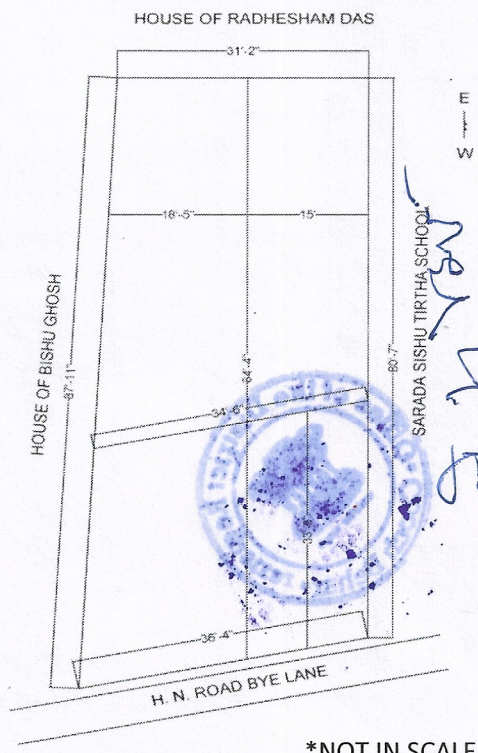

\*NOT IN SCALE

*Handwritten signatures and names:*  
 Sarada Sishu Tirtha School  
 Mridul Das  
 Mrinal Das  
 Rita Mitra

As Per Deed NO 3898 of 1989 of DSR Coochbehar

| TOUZI NO | KHATIAN NO | TOTAL LAND | TOTAL RENT | PLOT NO                | NAME OF DEVELOPER                      | KHATIAN NO L. R. | PLOT NO L.R.           | PARTICULARS OF LAND AREA IN |     |                            |      |        |  |
|----------|------------|------------|------------|------------------------|--|------------------|------------------------|-----------------------------|-----|----------------------------|------|--------|--|
|          |            |            |            |                        |  |                  |                        | ACRE                        | BKD | SQ. FT.                    | RENT | COLOUR |  |
|          | L. R. 7147 | 4 KATHAS   |            | R.S. 6998/P, L.R. 9460 | EVANGEL INDIA INFRASTRUCTURE PVT. LTD. | L.R. 7147        | R.S. 6998/P, L.R. 9460 |                             |     | 4 KATHAS i.e. 2880 Sq. ft. |      |        |  |